

Victorian Puzzle Purse template

The oldest Valentine in the Postal Museum collection dates from about 1790. Called the Puzzle Purse Valentine, it is a single large sheet of paper folded to a smaller size. Once received, the puzzle is to unfold it in the right way to read the verses handwritten on the folds, and see the small illustrations. Cut out and use this template to make your own puzzle purse. You can even add your own message and decoration.

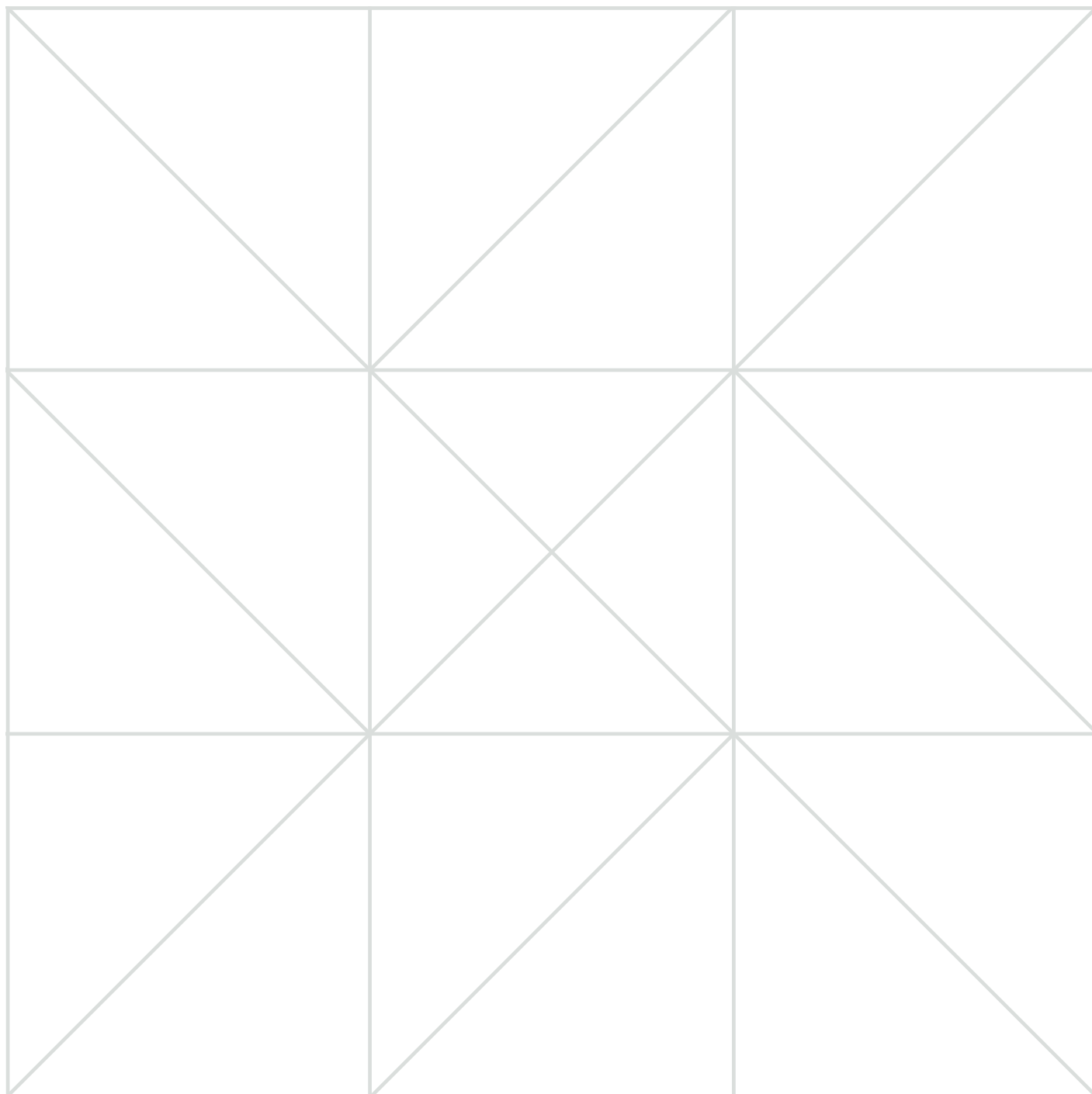

Victorian Puzzle Purse template

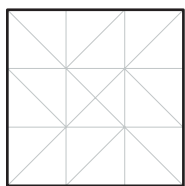

Step 1

Place square face up (guidelines visible).

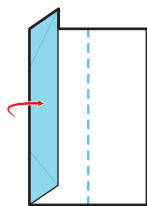

Step 2

Fold paper into thirds vertically. Unfold.

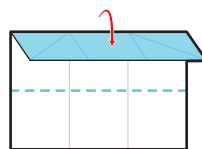

Step 3

Repeat, folding paper into thirds horizontally. Unfold.

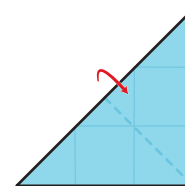

Step 4

Fold diagonally in half to make a triangle. Unfold. Repeat for other corner.

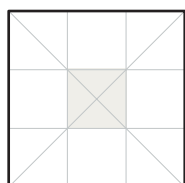

Tip

Your square will now be divided into nine equal boxes. Write your valentines message in the central box.

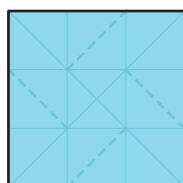

Step 5

Turn over square so it is face down (guidelines not visible).

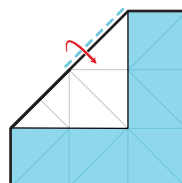

Step 6

Fold top left-hand corner to bottom right-hand corner of central box. Fold along guideline. Unfold. Repeat for all corners. Unfold.

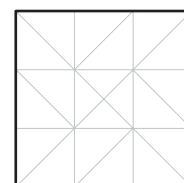

Step 7

Turn face up for final steps (guidelines visible). All guidelines should have now been folded.

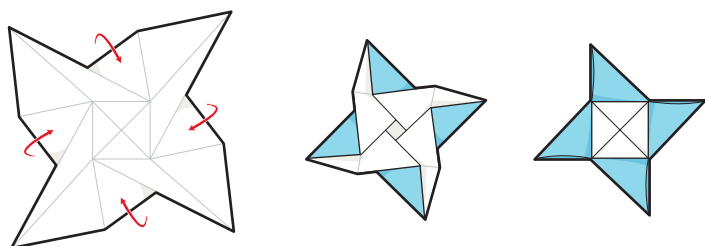

Step 8

Holding top right corner with right hand and bottom left corner with left hand, gently push corners round clockwise to make a 'pinwheel'.

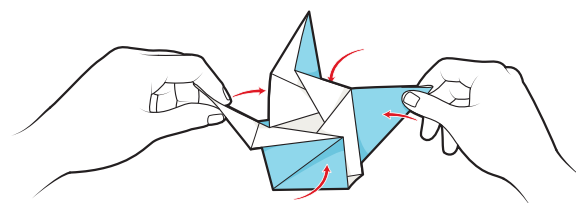

Tip

This shape is called a 'pinwheel'. Try pinching the corners into triangles and twisting to complete step 8.

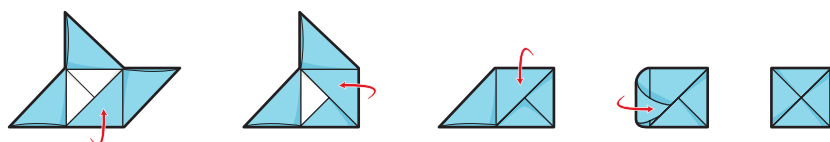

Step 9

Fold bottom arm up. Continue folding the arms, anti-clockwise, on top of another. The final arm should tuck in under the first arm.